

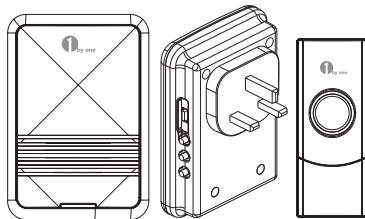

EasyChime

All products with the EasyChime logo can work together



1byone Products Inc.
1230 E Belmont Street, Ontario, CA 91761
Customer Service: +1 909-391-3888
www.1byone.com

Instruction Manual
SKU:OUKQH-0536

Thank you for purchasing this 1byone Wireless Doorbell. Please read this instruction manual before use to ensure safe operation.

1. Package Contents:

- 2 x Doorbell receivers (1 x battery-operated receiver and 1 x Plug-in receiver)
- 1 x Push button
- 1 x 3V Battery for push button (Type: CR2032)
- 1 x Double-sided adhesive
- 3 x Wall plugs and 3 x Screws
- 1 x Instruction manual

If any package contents are visibly damaged or missing, please immediately contact 1byone Support Center at <https://www.1byone.com/Support> for assistance.

2. Parts Names:

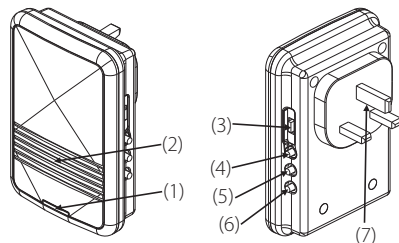
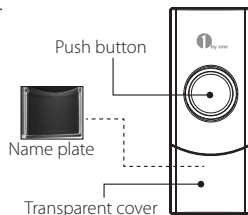

Receiver front side

Receiver back side

- 1. LED indicator
- 3. Sound and flash switch
- 5. Ringtone selector button
- 7. Plug

- 2. Speaker
- 4. Volume button
- 6. Pairing button

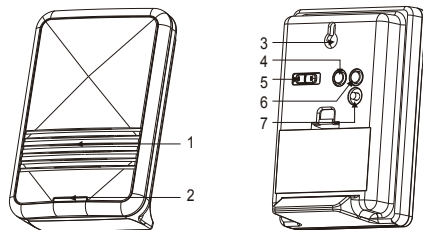

1. Speaker
2. LED indicator
3. Wall mounting hole
4. Volume button
5. Sound and flash switch
6. Ringtone selector button
7. Pairing button

Parameters:

Voltage of battery-operated receiver	DC 3V (2 x AA batteries)
Voltage of plug-in receiver	AC 220-240V
Voltage of push button	DC 3V (CR2032 battery)
Frequency	433.92MHz+100KHz
Operating range	100m/300ft (without obstacles)
Power consumption:	Receiver: <0.3W Push button: <10mA
Receiver's ring volume	Over 85dB within 0.5m/1.64ft
Working temperature	-20 C ~50 C

3. Power supply:

Battery-operated receiver: The receiver is powered by 2 x AA batteries. Please insert the batteries using the following procedure:

- a) Press the buckle on the battery compartment cover and remove the battery compartment cover at the back of the receiver.

- b) Insert the 2 x AA batteries using the correct polarity to eliminate the danger of fire.
- c) Reattach the battery compartment cover.

Plug in receiver: Please plug into a safety power outlet.

Push button: The push button is powered by a 3V battery (Type: CR2032). Please insert the battery using the following procedure:

- a) Insert a screwdriver into the small access port at the bottom of the push button and remove the push button's back cover.
- b) Insert the 3V battery (type CR2032) into the battery compartment, making sure the battery surface marked with a "+" is facing upwards.
- c) Reinsert the back cover, making sure it is securely closed to ensure IP protection.

Note:

If the performance of the push button deteriorates or completely stops, the battery might be exhausted. Please replace with another 3V type CR2032 battery.

Weak batteries can greatly reduce the ringtone volume of the receiver, please change the batteries every 8-10 months.

Safety note:

For the plug-in receiver:

- Please plug it into a safe power outlet
- Do not expose the receiver to water spray or water drops and do not place liquid-filled objects such as vases or opened drink containers on or near the receiver and the outlet.
- Unplug the receiver immediately if you sense a burning smell or smoke. Have qualified personnel check the receiver before using it again.
- Unplug the receiver from the outlet if the doorbell system is not to be used for an extended period of time.

For the battery-operated receiver and push button:

- Weak battery can greatly reduce the ringtone of the receiver, please replace with the same voltage and type batteries every 8-10 months.

- Always insert the battery using the correct polarity to eliminate the danger of fire.
- Keep old and new batteries away from children.
- Old batteries should be properly disposed using safe environmental practices.
- Remove the batteries from the receiver and push button if the doorbell system is not to be used for an extended period of time.

4. Operation:

A. Selecting the notification mode:

The doorbell receiver can notify after the push button has been pressed by playing a ringing sound, flashing an LED, or ringing and flashing an LED at the same time. These are referred to as Sound, Flash, and Sound + Flash mode.

To select the notification mode, switch the sound and flash switch to one of the following positions:



Sound only mode



Flash only mode



Sound + Flash mode

B. Selecting the ringtone:

There are 36 programmable ringtones for selection.

Press the Ringtone selector button  to change the ringtone.

Stop pressing this button when you have reached the desired ringtone.

C. Adjusting ringtone volume:

Press the volume button ^{VOL} $\frac{1}{2}/3$ until the desired volume is set. There are 3 volume levels for selection.

D. Pairing additional push buttons/receivers to the doorbell system:

Up to 5 push buttons can be paired with one receiver. You can also extend the wireless doorbell system with any number of receivers.

This is only possible if the push button and receiver are working on the same frequency.

Pair additional push buttons/receivers using the same pairing process as described below:

The following pairing instructions are relevant

to receiver (SKU: O00QH-0504) and push button (SKU: O00QH-0503).

Press the pairing button  on the receiver.

Next press the push button. If pairing is successful, the receiver should ring. It normally takes about 10 seconds for the push button and receiver to pair. If there is no pairing within 10 seconds, the receiver will exit the pairing mode. Please try pairing again.

E. Re-pairing function:

If a receiver starts ringing even when the push button hasn't been pressed, or a push button interferes with other receivers, it may be necessary to wipe the current pairings and pair again.

To reset the push buttons, you need to cut off the power supply for the receiver and push button.

Remove the battery from the push button and unplug the receiver from the power outlet. Then re-attach them to power after 30 seconds. You can now pair the desired push buttons.

5. Installation:

Plug-in receiver: Plug it into a safety power outlet.

Battery-operated receiver: The receiver can be mounted on a wall or just put on a flat surface.

To be mounted on a wall:

Select a suitable location for the doorbell, usually close to your outside door.

Drill holes on the wall. Next push the wall plug into the drilled holes and then insert the screw into the wall plugs. Finally, mount the receiver with screw.

Push button: Install the push button by double-sided adhesive or by screws:

a. By double-sided adhesive:

Select a suitable location for the push button, usually close to your outside door.

Stick the push button to the wall using the included double-sided adhesive.

b. By screws:

- Select a suitable location for the doorbell, usually close to your outside door.
- Pierce the two pre-stamped grooves (A) on the inner side of the back cover with a pointed object. Drill holes on the wall. Next push the wall plugs into the drilled holes and screw the back cover onto the wall with screws.
- Push the front cover onto the back cover and make sure it is securely closed to ensure IP protection.

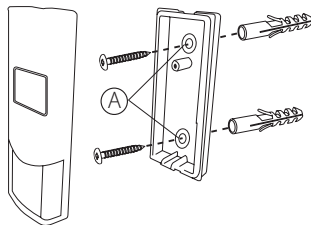

Notes:

- The push button and receiver can connect with a range up to 100m/300ft without any obstacles.
- The push button's transmitting frequency is 433MHz and its range can be affected by metal ,walls, concretes, and interfering signals from other electronic appliances with the same frequency including televisions, radios, and cookers.
- Please do not install the push button and receiver near to the above mentioned electronic appliances.
- Please test the operating range of the receiver and push button in your home before installation.
- Do not install the push button and receiver near any source of naked flames such as lighted candles.
- Do not expose the push button and receiver to direct sunlight or high temperatures, otherwise overheating may cause them irreparably damaged.

c. Install the name plate:

Remove the transparent cover from the push button.

Then write your name or room number on a small paper (size: 2.3cm/0.9in x 2.0cm/0.8in). Next, put the small paper into the transparent cover and then put back the transparent cover on the push button.

Note:

If you make the name plate by hand, be sure to use a waterproof pen.

6. Trouble Shooting:

- a. The receiver rings without the push button being pressed.
The receiver may be matched on the same frequency with nearby push buttons. You should wipe the pairing and re-pair your push button(s).
- b. There is no ring/LED flash when the push button is pressed.
 - Check whether the battery (CR2032) is inserted into the push button.

- For the plug-in receiver, check whether the power supply for the receiver is working properly.
- Pair the receiver and push button again.
- For the battery-operated receiver, check whether the batteries are inserted into the receiver.

c. The ringtone volume is greatly reduced.

A weak battery can reduce the ringtone volume of the receiver. Please change the battery every 10-12 months.

Metal constructions, walls, and other appliances with the same frequency can also affect the receiver's ringing effect. Avoid mounting the push button and receiver near any metal objects.

Disposal

Disposal of the appliance



Under no circumstances should you dispose of the appliance with normal domestic waste. This product is subject to the provisions of European Directive 2012/19/EU.

Dispose of the appliance via an approved disposal company or your municipal waste facility. Please observe the currently applicable regulations. Please contact your waste disposal centre if you need any further information.

Disposal of batteries



Used batteries may not be disposed of with household waste.

All consumers are statutorily required to dispose of batteries at a collection point provided by their local municipality or retail store. The purpose of this obligation is to ensure

batteries are disposed of in a non-polluting manner. Only dispose of batteries when they are fully discharged.



The appliance's packaging is made from environmentally friendly material and can be disposed of at your local recycling plant.

Declaration of Conformity

We, the 1byone Products Inc. confirm that the appliance as detailed below do comply with all essential requirements of the EMC directive 2014/53/EU and governing EU-regulations as mentioned below.

Article Description: Wireless Doorbell

Brand Name: 1byone

Model Number: OUKQH-0536

Governing EU-regulations: RoHS Directive 2011/65/EU
WEEE 2012/19/EU

Applicable Standard(s):

EN 301 489-1 V2.2.0

EN 301 489-3 V2.1.1

EN 300 220-2 V3.1.1

EN 62479:2010

EN 60065:2014

A handwritten signature in black ink, appearing to read 'Ray Tang'.

Ray Tang
Department Manager

Customer Service/Kundenservice
Service Clients/Atención al cliente
Assistenza Clienti/カスタマーサービス

US

To ensure speedy handling of your issue, please call
or email us for assistance.

Phone: +1 909-391-3888

(Mon-Fri 9:00am - 6:00pm PST)

Email: ushelp@1byone.com

UK

To ensure speedy handling of your issue, please call
or email us for assistance.

Phone: +44 158 241 2681

(Mon-Fri 9:00am - 6:00pm UTC)

Email: ukwebhelp@1byone.com

FR

Pour vous assurer une assistance rapide en cas de
problème, veuillez envoyer un e-mail.

Email: euhelp@1byone.com

IT

Per supporto immediato in caso di bisogno, la
invitiamo a contattarci via email.

Email: euhelp@1byone.com

CA

To ensure speedy handling of your issue, please
email us for assistance.

Email: cahelp@1byone.com

DE

Für eine zügige Bearbeitung ihres Problems, melden
Sie sich bei uns wie folgt.

Email: euhelp@1byone.com

ES

Para garantizar una rápida atención de su problema,
favor envíenos un email para ayudarlo.

Email: euhelp@1byone.com

JP

お客様の問題が直ちに解決されるため、ぜひメール
にて弊社までご連絡ください。

Eメール: jphelp@1byone.com